



Couplings

Multi-Beam - Multi-Helix Flexible Beam Coupling

Backlash Free - 6 Beam Clamp Fixing

Material

707:
Aluminium L168
(HE15TF)

703:
Stainless Steel
303 S3U

711:
Acetal

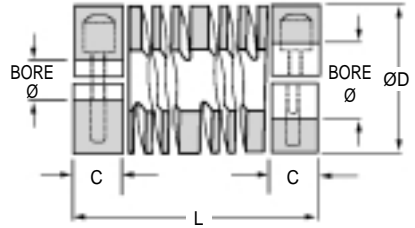

Other Info.

Pilot Bore size not toleranced.

PB = Pilot Bored

Finished Bore sizes to H7 Limits.

Max. torque rating for momentary loads only.

If chamber modified torque figures will change.

We can modify stock bore sizes.



PART NUMBER	Min Bore	Max Bore	ØD	L	C	Screw	Angular Offset	Parallel Offset	Torque Nm	
									Shock & Reversing	Max Torque
ALUMINIUM										
707.09	3mm	3/16"	3/8"	0.770"	0.208"	M1.6	3°	0.12	0.25	1.00
707.13	3/16"	1/4"	1/2"	0.900"	0.250"	M2	5°	0.17	0.50	2.00
707.16	5mm	8mm	5/8"	1.000"	0.250"	M2.5	5°	0.20	0.85	3.40
707.19	6mm	10mm	3/4"	1.040"	0.250"	M2.5	7°	0.25	1.33	5.30
707.25	8mm	1/2"	1"	1.500"	0.432"	M3	7°	0.38	2.50	10.00
707.32	10mm	16mm	1.25"	2.250"	0.625"	M4	7°	0.50	3.75	15.00
707.38	12mm	3/4"	1.50"	2.630"	0.708"	M5	7°	0.60	5.50	22.00
707.44	1/2"	7/8"	1.75"	3.000"	0.787"	M5	7°	0.80	7.50	30.00
707.51	5/8"	26mm	2.00"	3.750"	0.984"	M6	7°	0.90	10.00	40.00
707.57	3/4"	1-3/16"	2.25"	5.120"	1.250"	M6	7°	0.95	13.75	55.00
707.64	25mm	36mm"	2.50"	5.900"	1.500"	M8	7°	1.00	18.75	75.00
STAINLESS										
703.09	3mm	3/16"	3/8"	0.770"	0.208"	M1.6	3°	0.12	0.38	1.50
703.13	3/16"	1/4"	1/2"	1.000"	0.250"	M2	5°	0.17	0.75	3.00
703.16	5mm	8mm	5/8"	1.000"	0.250"	M2.5	5°	0.20	1.25	5.00
703.19	6mm	10mm	3/4"	1.100"	0.250"	M2.5	7°	0.25	2.00	8.00
703.25	8mm	1/2"	1"	1.500"	0.432"	M3	7°	0.38	4.00	16.00
703.32	10mm	16mm	1.25"	2.250"	0.625"	M4	7°	0.50	6.25	25.00
703.38	12mm	3/4"	1.50"	2.630"	0.708"	M5	7°	0.60	9.00	36.00
703.44	1/2"	7/8"	1.75"	3.000"	0.787"	M5	7°	0.80	12.00	48.00
703.51	5/8"	26mm	2.00"	3.750"	0.984"	M6	7°	0.90	18.25	73.00
703.57	3/4"	1-3/16"	2.25"	5.120"	1.250"	M6	7°	0.95	25.50	102.00
703.64	25mm	36mm"	2.50"	5.900"	1.500"	M8	7°	1.00	35.00	140.00
ACETAL										
711.13	3/16"	1/4"	1/2"	0.900"	0.250"	M2	5°	0.17	0.13	0.50
711.16	5mm	8mm	5/8"	1.000"	0.250"	M2.5	5°	0.20	0.23	0.90
711.19	6mm	10mm	3/4"	1.040"	0.250"	M2.5	7°	0.25	0.33	1.30
711.25	8mm	1/2"	1"	1.500"	0.432"	M3	7°	0.38	0.63	2.50
711.32	10mm	16mm	1.25"	2.250"	0.625"	M4	7°	0.50	1.00	4.00
711.38	12mm	3/4"	1.50"	2.630"	0.708"	M5	7°	0.60	1.50	6.00



Mechanical Components Inc.

Phone: 516-867-5665 Toll Free: 1-888-260-RINO Fax: 516-867-5656



Couplings

Multi-Beam - Multi-Helix Flexible Beam Coupling Backlash Free - 6 Beam Set Screw Fixing

Material

706:
Aluminium L168
(HE15TF)

702:
Stainless Steel
303 S3U

710:
Acetal

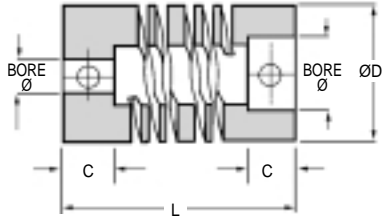

Other Info.

Finished Bore sizes to H7 Limits.

Max. torque rating for momentary loads only.

If chamber modified torque figures will change.

We can modify stock bore sizes.



PART NUMBER	Min Bore	Max Bore	ØD	L	C	Screw	Angular Offset	Parallel Offset	Torque Nm	
									Shock & Reversing	Max Torque
ALUMINIUM										
706.39	3mm	3/16"	3/8"	0.770"	0.208"	M2.5	3°	0.12	0.25	1.00
706.13	3/16"	1/4"	1/2"	0.900"	0.250"	M3	5°	0.17	0.50	2.00
706.16	5mm	8mm	5/8"	1.000"	0.250"	M4	5°	0.20	0.85	3.40
706.19	6mm	10mm	3/4"	1.040"	0.250"	M4	7°	0.25	1.33	5.30
706.25	8mm	1/2"	1"	1.500"	0.432"	M5	7°	0.38	2.50	10.00
706.32	10mm	3/4"	1.25"	2.250"	0.625"	M6	7°	0.50	3.75	15.00
706.38	12mm	7/8"	1.50"	2.630"	0.708"	M6	7°	0.60	5.50	22.00
706.44	1/2"	1"	1.75"	3.000"	0.787"	M4	7°	0.80	7.50	30.00
706.51	5/8"	28mm	2.00"	3.750"	0.984"	M8	7°	0.90	10.00	40.00
706.57	3/4"	32mm	2.25"	5.120"	1.250"	M8	7°	0.95	13.75	55.00
706.64	25mm	1-1/2"	2.50"	5.900"	1.500"	M8	7°	1.00	18.75	75.00
STAINLESS										
702.09	3mm	3/16"	3/8"	0.770"	0.208"	M2.5	3°	0.12	0.38	1.50
702.13	3/16"	1/4"	1/2"	1.000"	0.250"	M3	5°	0.17	0.75	3.00
702.16	5mm	8mm	5/8"	1.000"	0.250"	M4	5°	0.20	1.25	5.00
702.19	6mm	10mm	3/4"	1.100"	0.250"	M4	7°	0.25	2.00	8.00
702.25	8mm	1/2"	1"	1.500"	0.432"	M5	7°	0.38	4.00	16.00
702.32	10mm	3/4"	1.25"	2.250"	0.625"	M6	7°	0.50	6.25	25.00
702.38	12mm	7/8"	1.50"	2.630"	0.708"	M6	7°	0.60	9.00	36.00
702.44	1/2"	1"	1.75"	3.000"	0.787"	M4	7°	0.80	12.00	48.00
702.51	5/8"	28mm	2.00"	3.750"	0.984"	M8	7°	0.90	18.25	73.00
702.57	3/4"	32mm	2.25"	5.120"	1.250"	M8	7°	0.95	25.50	102.00
702.64	25mm	1-1/2"	2.50"	5.900"	1.500"	M8	7°	1.00	35.00	140.00
ACETAL										
710.13	3/16"	1/4"	1/2"	0.900"	0.250"	M3	5°	0.17	0.13	0.50
710.16	5mm	8mm	5/8"	1.000"	0.250"	M4	5°	0.20	0.23	0.90
710.19	6mm	10mm	3/4"	1.040"	0.250"	M4	7°	0.25	0.33	1.30
710.25	8mm	1/2"	1"	1.500"	0.432"	M5	7°	0.38	0.63	2.50
710.32	10mm	3/4"	1.25"	2.250"	0.625"	M6	7°	0.50	1.00	4.00
710.38	12mm	7/8"	1.50"	2.630"	0.708"	M6	7°	0.60	1.50	6.00



Mechanical Components Inc.

Phone: 516-867-5665 Toll Free: 1-888-260-RINO Fax: 516-867-5656



Couplings

Multi-Beam - Multi-Helix Flexible Beam Coupling

Backlash Free - 3 Beam Clamp Fixing

Material

725:
Aluminium L168
(HE15TF)
721:
Stainless Steel
303 S3U
729:
Acetal

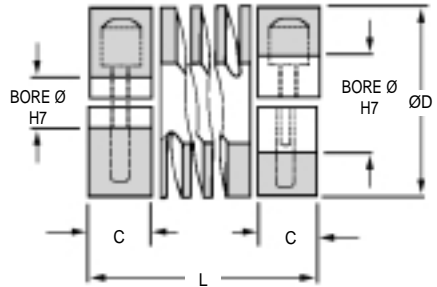
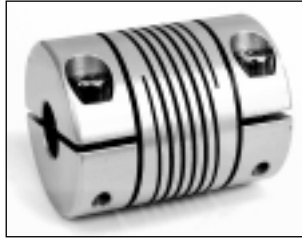

Other Info.

Pilot Bore size not toleranced.

PB = Pilot Bored

Finished Bore sizes to H7 Limits.

Max. torque rating for momentary loads only.

If chamber modified torque figures will change.

We can modify stock bore sizes.

PART NUMBER	Min Bore	Max Bore	ØD	L	C	Screw	Angular Offset	Parallel Offset	Torque Nm	
									Shock & Reversing	Max Torque
ALUMINIUM										
725.09	3mm	1/8"	3/8"	0.560"	4.5mm	M1.6	3°	0.004	0.10	0.40
725.13	4mm	5mm	1/2"	0.750"	6mm	M2	5°	0.005	0.23	0.90
725.16	5mm	1/4"	5/8"	0.800"	6.5mm	M2.5	5°	0.005	0.38	1.50
725.19	6mm	5/16"	3/4"	0.900"	6.5mm	M2.5	5°	0.005	0.63	2.50
725.25	8mm	7/16"	1"	1.250"	9mm	M3	5°	0.005	1.00	4.00
725.32	10mm	14mm	1-1/4"	1.750"	12mm	M4	5°	0.005	1.50	6.00
STAINLESS										
721.09	3mm	1/8"	3/8"	0.560"	4.5mm	M1.6	3°	0.004	0.13	0.50
721.13	4mm	5mm	1/2"	0.750"	6mm	M2	5°	0.005	0.25	1.00
721.16	5mm	1/4"	5/8"	0.800"	6.5mm	M2.5	5°	0.005	0.45	1.80
721.19	6mm	5/16"	3/4"	0.900"	6.5mm	M2.5	5°	0.005	0.68	2.70
721.25	8mm	7/16"	1"	1.250"	9mm	M3	5°	0.005	1.50	6.00
721.32	10mm	14mm	1-1/4"	1.750"	12mm	M4	5°	0.005	2.50	10.00
ACETAL										
729.13	4mm	5mm	1/2"	0.750"	6mm	M2	5°	0.005	0.06	0.24
729.16	5mm	1/4"	5/8"	0.800"	6.5mm	M2.5	5°	0.005	0.09	0.35
729.19	6mm	5/16"	3/4"	0.900"	6.5mm	M2.5	5°	0.005	0.16	0.64
729.25	8mm	7/16"	1"	1.250"	9mm	M3	5°	0.005	0.35	1.40
729.32	10mm	14mm	1-1/4"	1.750"	12mm	M4	5°	0.005	0.63	2.50



Mechanical Components Inc.

Phone: 516-867-5665 Toll Free: 1-888-260-RINO Fax: 516-867-5656



Couplings

Multi-Beam - Multi-Helix Flexible Beam Coupling Backlash Free - 3 Beam Set Screw Fixing

Material

724:
Aluminium L168
(HE15TF)

720:
Stainless Steel
303 S3U

728:
Acetal

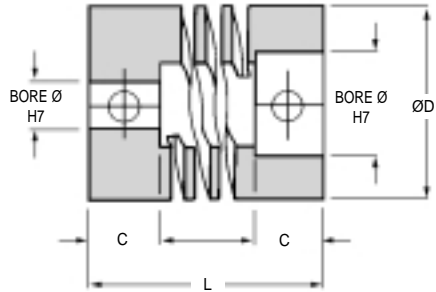

Other Info.

Pilot Bore size not toleranced.

PB = Pilot Bored

Finished Bore sizes to H7 Limits.

Max. torque rating for momentary loads only.

If chamber modified torque figures will change.

We can modify stock bore sizes.

PART NUMBER	Min Bore	Max Bore	ØD	L	C	Screw	Angular Offset	Parallel Offset	Torque Nm	
									Shock & Reversing	Max Torque
ALUMINIUM										
724.06	2mm	3mm	14"	1/2"	1.800"	M2	3°	0.003	0.10	0.40
724.09	3mm	1/8"	3/8"	0.560"	4.5mm	M2.5	3°	0.004	0.10	0.40
724.13	4mm	5mm	1/2"	0.750"	6mm	M3	5°	0.005	0.23	0.90
724.16	5mm	1/4"	5/8"	0.800"	6.5mm	M4	5°	0.005	0.38	1.50
724.19	6mm	5/16"	3/4"	0.900"	6.5mm	M4	5°	0.005	0.63	2.50
724.25	8mm	7/16"	1"	1.250"	9mm	M5	5°	0.005	1.00	4.00
724.32	10mm	14mm	1-1/4"	1.750"	12mm	M6	5°	0.005	1.50	6.00
STAINLESS										
720.06	2mm	3mm	14"	1/2"	1.800"	M2	3°	0.003	0.11	0.50
720.09	3mm	1/8"	3/8"	0.560"	4.5mm	M2.5	3°	0.004	0.13	0.50
720.13	4mm	5mm	1/2"	0.750"	6mm	M3	5°	0.005	0.25	1.00
720.16	5mm	1/4"	5/8"	0.800"	6.5mm	M4	5°	0.005	0.45	1.80
720.19	6mm	5/16"	3/4"	0.900"	6.5mm	M4	5°	0.005	0.68	2.70
720.25	8mm	7/16"	1"	1.250"	9mm	M5	5°	0.005	1.50	6.00
720.32	10mm	14mm	1-1/4"	1.750"	12mm	M6	5°	0.005	2.50	10.00
ACETAL										
728.13	4mm	5mm	1/2"	0.750"	6mm	M3	5°	0.005	0.06	0.24
728.16	5mm	1/4"	5/8"	0.800"	6.5mm	M4	5°	0.005	0.09	0.35
728.19	6mm	5/16"	3/4"	0.900"	6.5mm	M4	5°	0.005	0.16	0.64
728.25	8mm	7/16"	1"	1.250"	9mm	M5	5°	0.005	0.35	1.40
728.32	10mm	14mm	1-1/4"	1.750"	12mm	M6	5°	0.005	0.63	2.50



Mechanical Components Inc.

Phone: 516-867-5665 Toll Free: 1-888-260-RINO Fax: 516-867-5656