

RG

Precision Gear Racks

Rectangular Style

- Machined to AGMA 8 or 10 quality
- 416 Stainless Stress Relieved
- 20 Degree Pressure Angle
- Modifications and Custom Versions available
- Exact equals to many precision catalogue gear racks

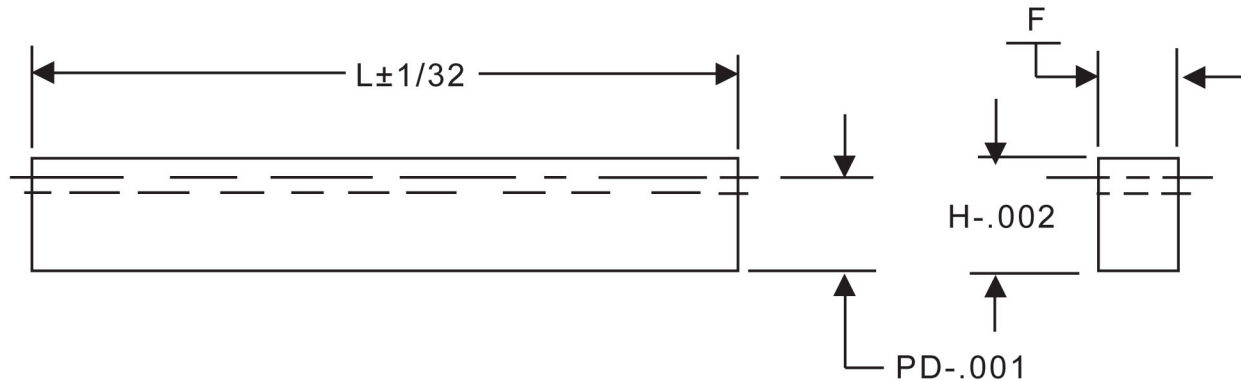

20° Pressure Angle

416 Stainless Steel

| Part Number | Pitch | P | L | F | H | AGMA |
|-------------|-------|-------|-----|------------|------|------|
| RG16S24-8 | 16 | .6675 | 24" | .365 ±.010 | .730 | 8 |
| RG20S24-8 | 20 | .6750 | 24" | .365 ±.010 | .730 | 8 |
| RG24S18-10 | 24 | .4383 | 18" | .230 ±.005 | .480 | 10 |
| RG31S18-10 | 1/10 | .4482 | 18" | .230 ±.005 | .480 | 10 |
| RG32S18-10 | 32 | .4487 | 18" | .230 ±.005 | .480 | 10 |
| RG48S18-10 | 48 | .4592 | 18" | .230 ±.005 | .480 | 10 |
| RG62S11-10 | 1/20 | .4641 | 11" | .230 ±.005 | .480 | 10 |
| RG64S11B-10 | 64 | .4644 | 11" | .230 ±.005 | .480 | 10 |
| RG72S11B-10 | 72 | .3411 | 11" | .167 ±.005 | .355 | 10 |
| RG80S11B-10 | 80 | .3425 | 11" | .167 ±.005 | .355 | 10 |
| RG96S11B-10 | 96 | .3446 | 11" | .167 ±.005 | .355 | 10 |
| RG120S11-10 | 120 | .3467 | 11" | .167 ±.005 | .355 | 10 |

rino Mechanical Components Inc.

216 North Main St. • Freeport, NY 11520 • 516-867-5665 fax: 516-867-5656

www.rinomechanical.com sales @rinomechanical.com

RG

Precision Gear Racks

Round Style

- Machined to AGMA 8 or 10 quality
- 416 Stainless Stress Relieved
- 20 Degree Pressure Angle
- Modifications and Custom Versions available
- Exact equals to many precision catalogue gear racks

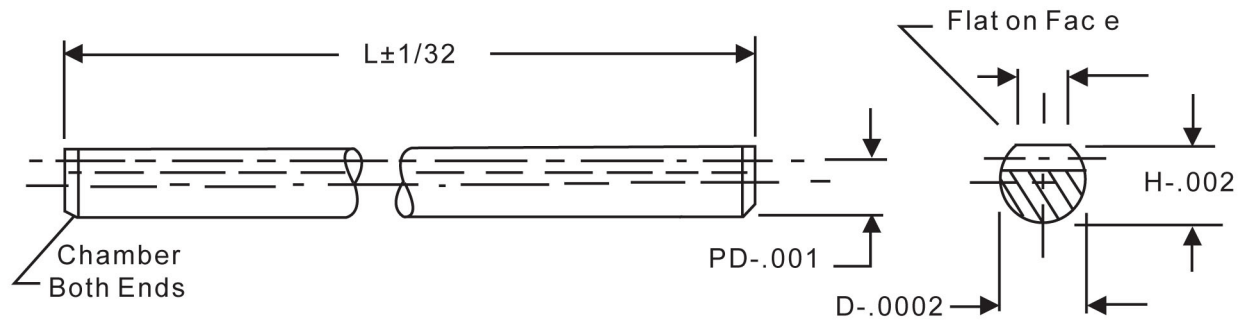

20° Pressure Angle

416 Stainless Steel

| Part Number | Pitch | P | L | D | F | H | AGMA |
|--------------|-------|-------|-----|--------------|------|------|------|
| RG16S24R-8 | 16 | .6175 | 24" | .7497 -.0004 | 7/16 | .680 | 8 |
| RG20S24R-8 | 20 | .4800 | 24" | .6247 -.0004 | 7/16 | .530 | 8 |
| RG24S18R-10 | 24 | .4383 | 18" | .4997 -.0002 | 3/16 | .480 | 10 |
| RG31S18R-10 | 1/10 | .3082 | 18" | .3747 -.0002 | 3/16 | .340 | 10 |
| RG32S18R-10 | 32 | .3087 | 18" | .3747 -.0002 | 3/16 | .340 | 10 |
| RG48S18R-10 | 48 | .1992 | 18" | .2497 -.0002 | 5/32 | .220 | 10 |
| RG62S11R-10 | 1/20 | .2042 | 11" | .2497 -.0002 | 5/32 | .220 | 10 |
| RG64S11R-10 | 64 | .2044 | 11" | .2497 -.0002 | 5/32 | .220 | 10 |
| RG72S11R-10 | 72 | .1421 | 11" | .1872 -.0002 | 1/8 | .156 | 10 |
| RG80S11R-10 | 80 | .1435 | 11" | .1872 -.0002 | 1/8 | .156 | 10 |
| RG96S11R-10 | 96 | .1456 | 11" | .1872 -.0002 | 1/8 | .156 | 10 |
| RG120S11R-10 | 120 | .1067 | 11" | .1247 -.0002 | 3/32 | .115 | 10 |

rino Mechanical Components Inc.

216 North Main St. • Freeport, NY 11520 • 516-867-5665 fax: 516-867-5656

www.rinomechanical.com sales@rinomechanical.com