

**BCA
BSA**

Aluminum Step-Beam™ Coupling

Superior bellows + beam coupling replacement

- + Zero Backlash!
 - + Higher torque (18 to 35%)
 - + Torsionally rigid design
 - + Increased reliability
 - + Superior radial and axial compensation
 - + Single Piece Construction
 - + Superior angular offset to 4°
- ...and at Lower Cost!



Free sample to qualified OEM's

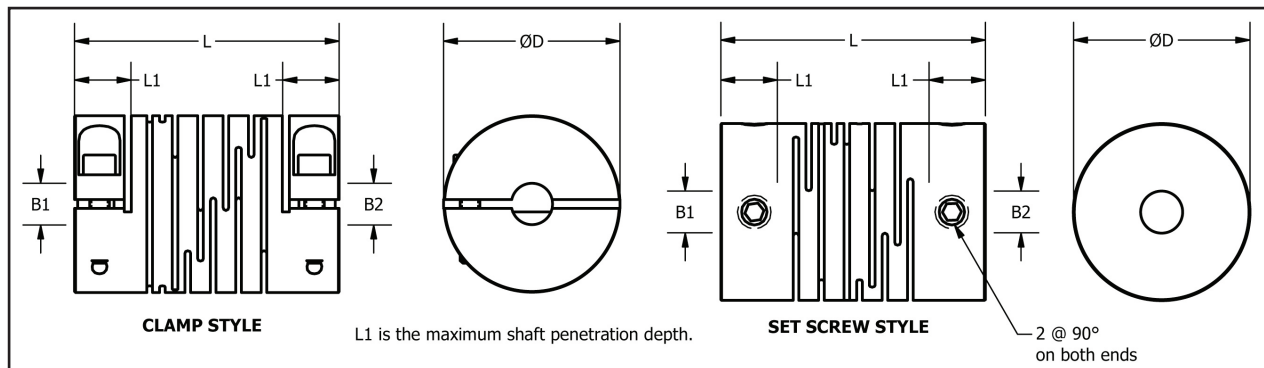

Aluminum - Clamp Type

Bores		Torque (In-Lbs)		Torsional Stiffness (in*lb/deg)	Offset			Moment of Inertia (lb*in ²)	ØD	L	L1	Cap Screw	Mass (Lb.)	Part Number
Min	Max	Rever-sing	Max		Max Ang.	Max Radial	Max Axial							
5mm	14mm	17	34	59	4°	0.015"	0.005"	0.010	1.00"	1.50"	.43"	M3	0.08	BCA25
1/4"	16mm	42	84	124	4°	0.020"	0.005"	0.040	1.25"	2.25"	.63"	M4	0.21	BCA32
5/16"	3/4"	80	159	246	4°	0.024"	0.005"	0.111	1.50"	2.62"	.71"	M5	0.36	BCA38

Specifications subject to change without notice

Aluminum - Set Screw Type

Bores		Torque (In-Lbs)		Torsional Stiffness (in*lb/deg)	Offset			Moment of Inertia (lb*in ²)	ØD	L	L1	Set Screw	Mass (Lb.)	Part Number
Min	Max	Rever-sing	Max		Max Ang.	Max Radial	Max Axial							
5mm	14mm	17	34	59	4°	0.015"	0.005"	0.010	1.00"	1.50"	.43"	M5	0.08	BSA25
1/4"	16mm	42	84	124	4°	0.020"	0.005"	0.040	1.25"	2.25"	.63"	M6	0.21	BSA32
5/16"	3/4"	80	159	246	4°	0.024"	0.005"	0.111	1.50"	2.62"	.71"	M6	0.36	BSA38

Specifications subject to change without notice

Material

Couplers: Aluminum Fastener: Stainless Steel

Performance

Temperature Range: -4°F to +284°F (-20°C to 140°C)

"Step-Beam™ is patented and registered trade mark of Rino Mechanical Components Inc."

rino Mechanical Components Inc.

216 North Main St. • Freeport, NY 11520 • 516-867-5665 fax: 516-867-5656
www.rinomechanical.com sales @rinomechanical.com